

PENN TOWNSHIP SECTION 11 R 12 TWP 9 MORGAN COUNTY, OHIO

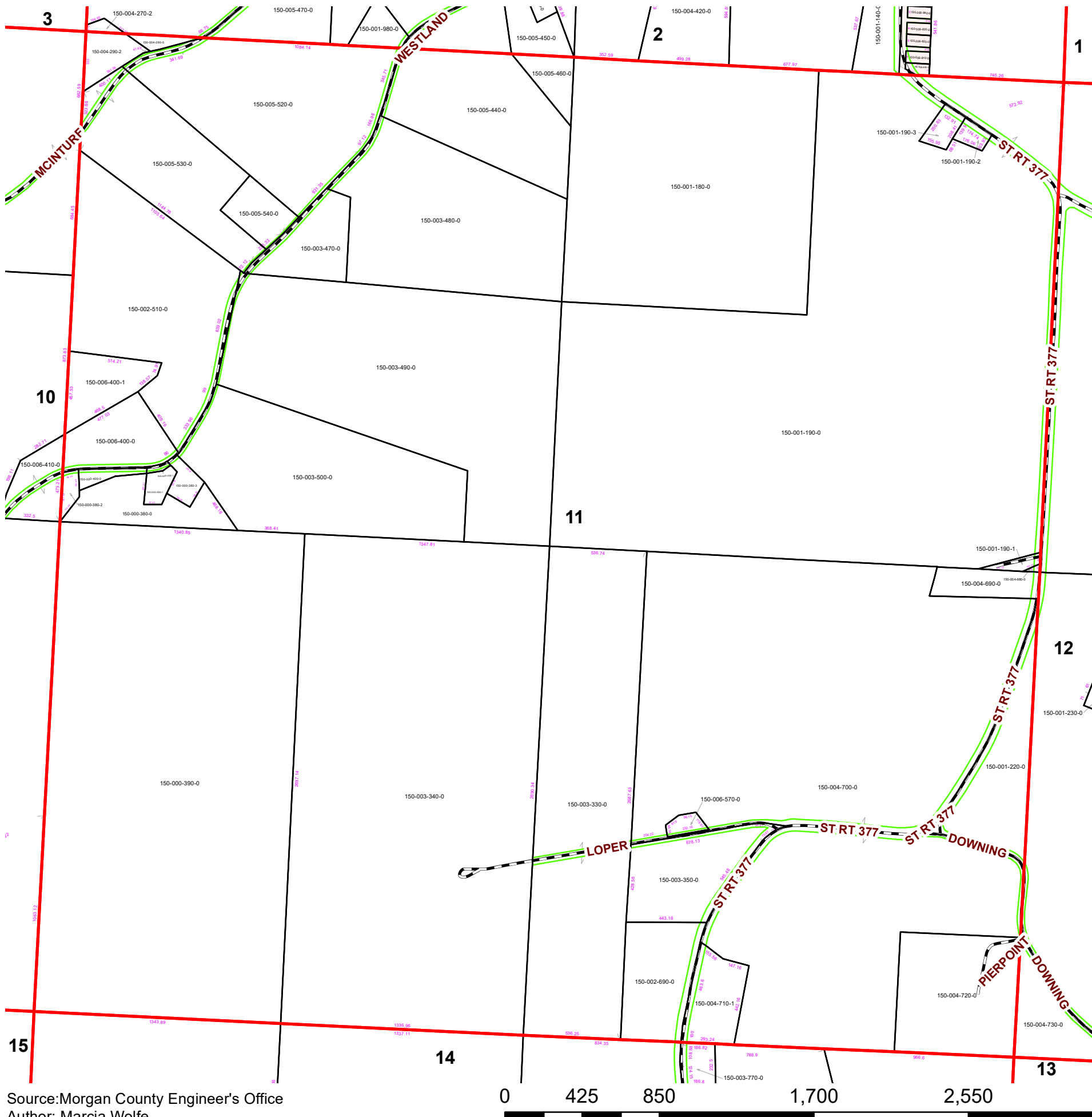

PIN	Owner	LegalDescr	Acres	VOL	PAGE	Survey_Ref
150-000-390-0	BOLE JANE A & TOD JAMES BOLE ET	R12 T09 S11 SD 7	82	OR234	4606	NoSurvey.pdf
150-000-400-0	BOLE JANE A & TOD JAMES BOLE ET	R12 T09 S11 SD 29	0.502	OR234	4606	PEN-0008.pdf
150-000-380-0	BOLE JANE A & TOD JAMES BOLE ET	R12 T09 S11 SD 6	4.081	OR234	4606	NoSurvey.pdf
150-000-380-1	BOLE JANE A & TOD JAMES BOLE ET	R12 T09 S11 SD 34	0.628	OR234	4606	PEN-0105.pdf
150-000-400-1	BOLE JANE A & TOD JAMES BOLE ET	R12 T09 S11 SD 35	0.126	OR234	4606	PEN-0105.pdf
150-000-380-3	BOLE TREVOR	R12 T09 S11 SD 41	0.72	OR224	1900	PEN-0318.pdf
150-003-350-0	CHORDAS LAURA E	R12 T09 S11 SD 16	6.897	OR219	1618	PEN-0199.pdf
150-001-220-0	DEARTH FARMS LLC	R12 T09 S11 SD 11	6.75	OR235	5756	NoSurvey.pdf
150-001-190-0	DEARTH FARMS LLC	R12 T09 S11 SD 1-3	122.82	OR235	5756	NoSurvey.pdf
150-001-180-0	DEARTH FARMS LLC	R12 T09 S11 SD 2-18	42.51	OR235	5756	NoSurvey.pdf
150-005-540-0	EWART DERRICK D	R12 T09 S11 SD 25	2	OR112	776	PEN-0200.pdf
150-005-530-0	EWART DERRICK D	R12 T09 S11 SD 22	13	OR112	776	PEN-0200.pdf
150-005-520-0	EWART DERRICK D	R12 T09 S11 SD 21	18.74	OR112	776	PEN-0200.pdf
150-004-290-2	GOHRING JONATHAN W	R12 T09 S11 SD 33	1.539	OR37	388	PEN-0093.pdf
150-001-190-2	JENNE KEVIN & DIXIE	R12 T09 S11 SD 37 SUR	0.488	OR62	245	PEN-0157.pdf
150-001-190-3	JENNE KEVIN & DIXIE	R12 T09 S11 SD 38 SUR	0.749	OR62	245	PEN-0167.pdf
150-003-500-0	MARTIN RITA J	R12 T09 S11 SD 17	20	OR174	372	NoSurvey.pdf
150-003-490-0	MARTIN RITA J	R12 T09 S11 SD 20	36	OR174	372	NoSurvey.pdf
150-003-470-0	MARTIN RITA J	R12 T09 S11 SD 24	4	OR174	372	NoSurvey.pdf
150-003-480-0	MARTIN RITA J	R12 T09 S11 SD 4	23.61	OR174	372	NoSurvey.pdf
150-003-330-0	MAYNARD JAMES T & MARCELLA LO	R12 T09 S11 SD 9 SUR	33.118	OR166	127	PEN-0237.pdf
150-003-340-0	MAYNARD JAMES T & MARCELLA LO	R12 T09 S11 SD 8 SUR	83.013	OR166	127	PEN-0237.pdf
150-004-290-0	MURPHEY DWIGHT G	R12 T09 S11 SD5	0.43	OR227	918	PEN-0291.pdf
150-002-690-0	PAGE TERRY L & LISA A	R12 T09 S11 SD 12	5.95	OR234	2612	NoSurvey.pdf
150-004-690-0	POWELL RICHARD O & DIANA L	R12 T09 S11 SD 26	2.07	D.V 193	609	NoSurvey.pdf
150-004-680-0	POWELL RICHARD O & DIANA L	R12 T09 S11 SD 27	0.05	D.V 193	609	NoSurvey.pdf
150-001-190-1	POWELL RICHARD O & DIANA L	R12 T09 S11 SD 36	0.377	OR18	42	PEN-0118.pdf
150-004-720-0	QUEEN EARL W	R12 T09 S11 SD 13	10	OR228	1695	NoSurvey.pdf
150-004-710-1	QUEEN PAUL EDWARD	R12 T09 S11 SD 32	3.276	OR117	577	PEN-0086.pdf
150-005-460-0	SCOTT DEAN P	R12 T09 S11 SD 14	1.51	OR81	108	NoSurvey.pdf
150-005-440-0	SCOTT DEAN P	R12 T09 S11 SD 19	12	OR81	108	NoSurvey.pdf
150-006-570-0	SHANKLAND ANGELA S	R12 T09 S11 SD 30	0.464	OR63	133	PEN-0037.pdf
150-004-700-0	WILDER DAVID G & HALIE M	R12 T09 S11 SD 10	97.701	OR234	1712	PEN-0341.pdf
150-000-380-2	ZAROS JASON	R12 T09 S11 SD 40	0.483	OR211	836	PEN-0289.pdf
150-006-400-1	ZAROS JASON AKA JASON J	R12 T09 S101 SD 39	3.153	OR202	2712	PEN-0198.pdf
150-002-510-0	ZAROS JASON AKA JASON J	R12 T09 S11 SD 23	19.54	OR202	2712	PEN-0272.pdf
150-006-400-0	ZAROS JASON J	R12 T09 S11 SD 15	3.972	OR202	2712	PEN-0198.pdf

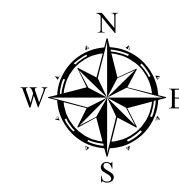

Boundaries			
	Hydro		Section
	Roads		Lot
	County		Township
	Parcel		ROW



Disclaimer: The information that these maps contains is for reference purposes only. Please bring any erros to the attention of the Engineer's Office staff. Thank you

